

Notes:

1. Structure: film+glass+tail (FPC)
 film: clear hardcoating $400\Omega/\square$ $T=0.188\text{mm}$
 surface hardness $\geq 3\text{H}$
 glass: $300\Omega/\square$ $t=2.0\text{mm}$
 tail: FPC 4 pin pitch=2.54mm
 total thickness: $2.30\pm 0.10\text{mm}$
2. Max Voltage: DC5V 1mA
3. Insulation Resistance: $\geq 10\text{M}\Omega$ (25V DC)
4. Linearity: $\leq 2.0\%$
5. Transmission: $\geq 80\%$
6. Operating Force: 50-100g
7. Touch Life: $\geq 1,000,000$ times
8. Response time after touch: $\leq 10\text{ms}$
9. Operation Condition: $-10^\circ\text{C} + 60^\circ\text{C}$, $\leq 90\%\text{RH}$
10. Storage Condition: $-20^\circ\text{C} + 70^\circ\text{C}$, $\leq 90\%\text{RH}$

PIN Assignment

pin1	Y1
pin2	X1
pin3	Y2
pin4	X2

比 例 1:1

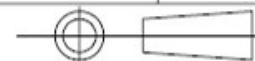

ITO. 0941工程图

设 计		日期	
审 核		日期	